



**Electrolux**  
PROFESSIONAL

## Food Holding Equipment SafeBox Hold

ITEM # \_\_\_\_\_

MODEL # \_\_\_\_\_

NAME # \_\_\_\_\_

SIS # \_\_\_\_\_

AIA # \_\_\_\_\_



240042 (SBXED5GS)

\* NOT TRANSLATED \*

### Main Features

- Keeps multiple packaged meals ready for pickup, preserving the food quality and safety.
- It is designed to serve restaurateurs active in take-away and delivery operations.
- Can accommodate large paper shoppers, paper boxes or pizza boxes (pizza diameter up to 33 cm).
- Features a ventilated heat system to envelop the packaged meals with hot air and preserve the original taste.
- The fast heat recovery in combination with the UVC lamp mounted on the ceiling also serves bactericidal and viricidal purposes.
- The unit fits 600 mm deep counters and does not require extra space for ventilation.
- The temperature can be set on the back of the unit and ranges from 60 to 85°C.
- The stacked units can be connected on the back and transfer energy from one to the others, requiring just 1 cord and 1 plug for the whole execution.
- Drop-down door to guarantee wide opening and comfort of operations for maximum flexibility on packaging sizes. The UVC lamp is activated only when the door is properly closed (verified via dedicated sensors). The handle incorporates a photocatalytic coating to guarantee antibacterial activity.
- It's possible to stack the unit with sliding door models, up to 3 units total, thus increasing capacity according to the customer's requirements with no extra space occupancy.

### Optional Accessories

- - NOT TRANSLATED - PNC 922418 ☐
- - NOT TRANSLATED - PNC 922642 ☐

APPROVAL: \_\_\_\_\_



Experience the Excellence  
[www.electroluxprofessional.com](http://www.electroluxprofessional.com)



**Electrolux**  
PROFESSIONAL

## Food Holding Equipment SafeBox Hold

### Electric

Supply voltage:	220-240 V/1 ph/50 Hz
Installed Power :	0.59 kW
Plug type:	UK-13A

### Key Information:

External dimensions, Width:	920 mm
External dimensions, Depth:	590 mm
External dimensions, Height:	450 mm
Net weight:	35 kg
Internal dimensions, Width:	725 mm
Internal dimensions, Depth:	420 mm
Internal dimensions, Height:	335 mm
Waterproof index:	IPX3

### Sustainability

Noise level:	48 dBA
--------------	--------

Front

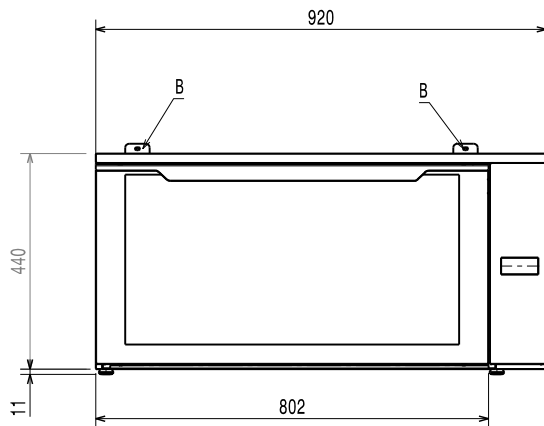

Side

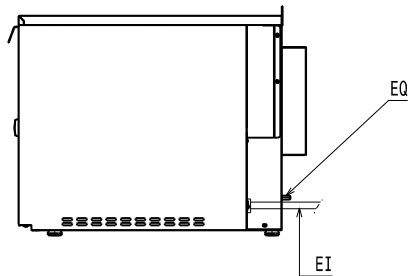

EI = Electrical inlet (power)

Top

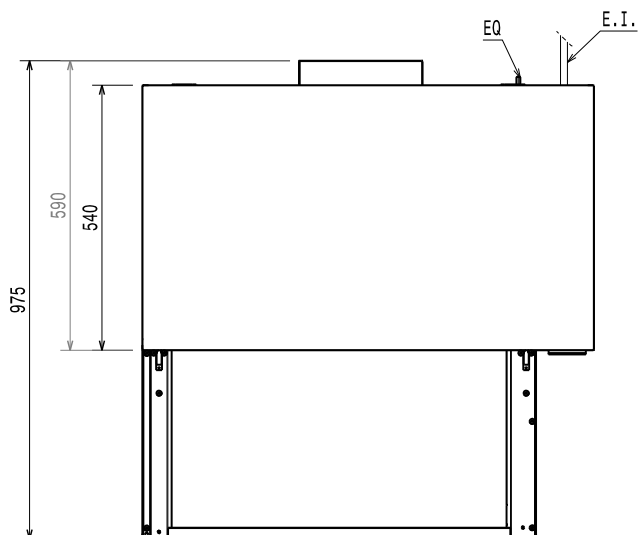

Food Holding Equipment  
SafeBox Hold

The company reserves the right to make modifications to the products without prior notice. All information correct at time of printing.

2025.04.20